

Origo™ Mig L305, L405

Origo™ Feed L302, L304

Reliable and easy-to-use welding package

The Origo™ Mig L305 and L405 welding package is ideal for welding applications within general steel fabrication, the vehicle industry and household and furniture manufacturers.

The package consists of the Origo™ Mig L305 and L405 power source, Origo™ Feed L302 or L304 wire feed unit, a connection set (1.7 m, 5.0 m or 10.0 m) and the PSF™ welding torch.

Reliable and easy to use

Origo™ Mig L305 and L405 are step-controlled power sources for MIG/MAG welding.

The Origo™ Mig L305 is a 10 voltage step unit and Origo™ Mig L405 40 voltage steps unit.

Electronically controlled feeding gives accurate and stable arc. The 4-wheel feed mechanism has grooves in the feed roller and idle pressure roller with ball bearing, which provides a positive and stable feeding combined with low wear on the wire. The 2-wheel feeder mechanism is a cost efficient solution for wire dimension up to 1,2 mm.

The feeders are available with Ø30 mm feed rollers for wires up to Ø1.2 mm (L302) and Ø1,6 mm (L304).

Easy settings

Wire feed speed, 2/4 stroke, creep start, spot welding, inching, gas purge and burnback time setting are made on the front panel of the feeder, giving a good overview of the settings. Voltage setting and inductance adjustments are made on the power source.

Available accessories

The easy to install Plastic bobbin option can protect the wire spool from dirt and dust.

Extra versatility is provided by the three wire feed mounting options; counterbalance and mast, wheel kit or a suspension bracket.

As an option the Origo™ Mig L305 and L405 can be equipped with a V/A digital meter and transformer for CO₂ heater.



With safety in mind

The Origo™ Feed is designed to meet the most rigid safety standard IEC/EN 60974-5 with low voltage (42 V/AC) operations complete with an overload device ensuring the best possible protection.

Service and support

ESAB has a large network of distributors and authorised service workshops. Should any problem arise with your ESAB Origo™ Mig, you can with confidence turn to your local dealer or authorised workshop, which are available at www.esab.com.

Applications

- General steel fabrication
- Vehicle industry
- Household and furniture

XA00123420

- **40 voltage steps** (Origo™ Mig L405), optimum settings for each application.
- **2/4 stroke**, simplifies welding.
- **Adjustable burnback timer** gives correct stick-out.
- **Creep start**, (L304) gradual feed of wire for ultimate starts.
- **Spot welding** (L304) for easy operation with pre-setting of the timer and equal lengths of the spots.
- **Gas Purge and Inching** (L304) no wastage wire or gas when initially setting up the equipment for welding or changing the wire spool.
- **Two inductance outlets**- easy to optimise settings for different applications.
- **IP 23** - fit for safe out of doors applications.
- **Easy-to-use control panel** for quick set up.

Technical data

	Origo™ Mig L305	Origo™ Mig L405
Mains voltage, V, Hz	400/415, 3~ 50	400/415, 3~ 50 230/400/415/500, 3~ 50 230/400/460, 3~ 60
Permitted load at		
25% duty cycle, A/V	300/29	
50% duty cycle, A/V		400 / 34
60% duty cycle, A/V	190 / 24	365 / 32
100% duty cycle, A/V	150 / 22	280 / 28
Setting range (DC), A/V	30 / 15 - 300 / 29	50 / 16,5 - 400 / 34
Open circuit voltage, V	17-40	17-45
Open circuit power, W	190	360
Power factor at maximum current	0,97	0,98
Efficiency at maximum current, %	69	71
Control voltage, V, Hz	42, 50/60	42, 50/60
Dimensions l x w x h, mm	782 x 425 x 830	812 x 552 x 925
Weight, kg	89	142
with cooling unit		156
Operating temperature, °C	-10 to +40	-10 to +40
Enclosure class	IP 23	IP 23
Application classification	S	S

Ordering information

Put together your package:

Power sources

Origo™ Mig L305 (400-415V 50Hz)	0349 309 700
Origo™ Mig L405 (400-415V 50Hz)	0349 306 517
Origo™ Mig L405 (230/400-415/500V 50Hz; 230/440-460V 60Hz)	0349 306 594
Origo™ Mig L405w (400-415V 50Hz)	0349 306 563
Origo™ Mig L405 VA-meter (400-415V 50Hz)	0349 313 090

Wire feed units

Origo™ Feed L302, Open	0459 495 782
Origo™ Feed L304, Open	0459 495 882
Origo™ Feed L304w, Open	0459 495 892

Connection cables

1.7 m, 50 mm ² for air and water-cooled feeder	0459 532 880
5.0 m, 50 mm ²	0459 532 881
10.0 m, 50 mm ²	0459 532 882
15.0 m, 50 mm ²	0459 532 883
5.0 m 50 mm ² water-cooled	0459 532 891
10.0 m 50 mm ² water-cooled	0459 532 892
15.0 m 50 mm ² water-cooled	0459 532 893

Torches

PSF™ 305 3 m	0458 401 880
PSF™ 305 4.5 m	0458 401 881
PSF™ 405 3 m	0458 401 882
PSF™ 405 4.5 m	0458 401 883
PSF™ 410w 3 m	0458 400 882
PSF™ 410w 4.5 m	0458 400 883

Options

Origo™ Mig

Digital instrument for Origo™ Mig L305	0349 302 598
Digital instrument for Origo™ Mig L405	0349 302 451
Transformer for CO ₂ heater	0349 302 250
Stabilizer (for Origo™ Mig L305)	0349 303 475
Stabilizer (for Origo™ Mig L405)	0349 303 474
Reinforcer kit for counterbalance	0349 309 748

Origo™ Feed

Water connection kit 1.7 m*	0459 564 880
Bobbin cover, plastic	0458 674 880
Wheel kit	0458 707 880
Strain relief for welding torch	0457 341 881
Strain relief for connection cables	0459 234 880
Quick connector MarathonPac™	F102 440 880
Lifting eye	0458 706 880
Adapter for 5 kg' s spool	0455 410 001
Counter balance device	0458 705 880
Turning piece	0458 703 880

* Used only for upgrading of wire feed units 0459 495 782/882 to "w" versions.

Technical data

	Origo™ Feed L302	Origo™ Feed L304
Power supply: (V ac, Hz)	42, 50/60	42, 50/60
Wire spool capacity: (kg)	18	18
Max. spool diameter: (mm)	300	300
Setting data		
Wire feed speed : (m/min)	1.5-22.0	1.5-22.0
Burnback time : (s)	0-0.7	0-0.7
Spot welding time : (s)	-	0.2 - 5.0
Dimension (l x w x h): (mm)	569 x 259 x 355	569 x 259 x 355
Incl bobbin cover:	687 x 271x 417	687 x 271x 417
Weight: (kg)	12.6	13.2
Wire dimensions: (mm)		
steel	0.6-1.2	0.6-1.6
stainless steel	0.6-1.2	0.6-1.2
aluminium	1.0-1.2	1.0-1.6
cored wire	0.8-1.2	0.8-1.6

Panel functions

	L302	L304
2/4 stroke	X	X
Burnback time	X	X
Creep start		X
Spot welding		X
Inching		X
Gas Purge		X

Wear parts Origo™ Feed L302

Wire Ø mm	Wire type	1 Feed roller	2 Pressure roller	3 Inlet nozzle	4 Insert tube	5 Outlet nozzle	Groove type
0.6 / 0.8	Fe, Ss, C	367556-001	455907-001	466074-001	455889-001	455886-001	V
0.8 / 1.0	Fe, Ss, C	367556-002	455907-001	466074-001	455889-001	455886-001	V
1.0 / 1.2	Fe, Ss, C	367556-003	455907-001	466074-001	455889-001	455886-001	V
1.0 / 1.2	Al	367556-004	455907-001	466074-001	455894-001	455885-001	U
	C=cored wire						

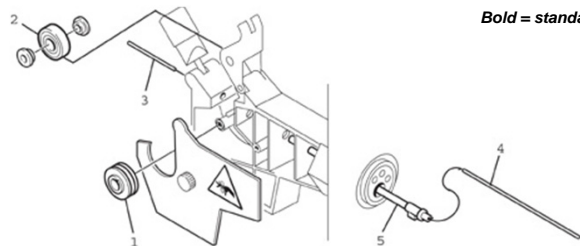

Bold = standard deliveries

Wear parts Origo™ Feed L304

Wire Ø mm	Wire type	1 Feed roller	2 Pressure roller	3 Inlet nozzle	4 Intermediate nozzle	5 Outlet nozzle	Groove type
0.6 / 0.8	Fe, Ss, C	369557-001	455907-001	455049-001	455072-002	469837-880	V
0.8 / 1.0	Fe, Ss, C	369557-002	455907-001	455049-001	455072-002	469837-880	V
1.0 / 1.2	Fe, Ss, C	369557-003	455907-001	455049-001	455072-002	469837-880	V
1.4 / 1.6	Fe, C	369557-013	455907-001	455049-001	455072-002	469837-880	V
0.8 / 0.9	Al	369557-011	455907-001	455049-001	456615-001	469837-881	U
1.0 / 1.2	Al	369557-006	455907-001	455049-001	456615-001	469837-881	U
	C=cored wire						

Bold = standard deliveries

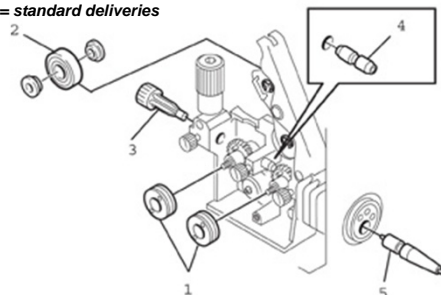

ESAB AB
Box 8004
SE-402 77 GÖTEBORG SWEDEN
Phone: +46 31 50 90 00 Fax +46 31 22 04 49
E-mail: info@esab.se

www.esab.com

