

I.281 | Impugnature cilindriche girevoli

Duroplasto

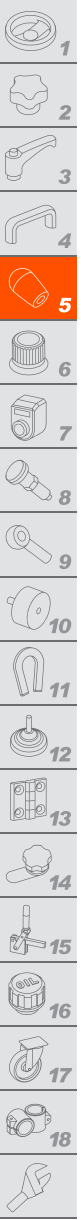

MATERIALE

Duroplasto a base fenolica (PF), colore nero, finitura lucida.

ESECUZIONI STANDARD

- **I.281**: foro passante liscio.
- **I.281+x**: perno in acciaio cromato opaco, testa cilindrica con cava esagonale.
- **I.281+x-SST**: perno in acciaio INOX AISI 304, testa cilindrica con cava esagonale.
- **I.281+x+Gh**: perno e controdado di bloccaggio in acciaio cromato opaco, testa cilindrica con cava esagonale.

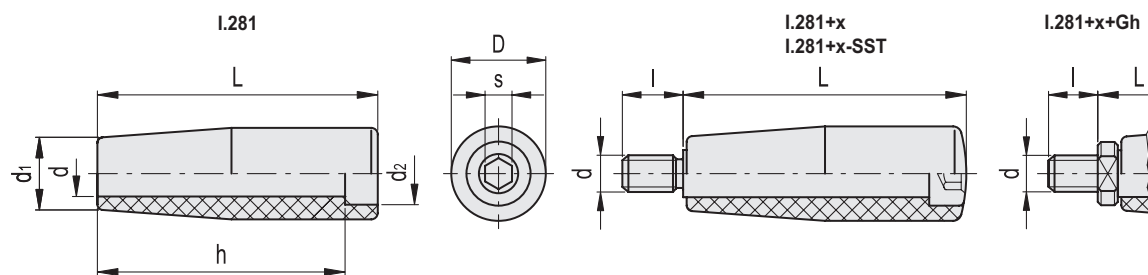

I.281

| Codice | Descrizione | D | L | d | d1 | d2 | h | ⚖ |
|--------|-------------|----|-----|----|----|----|----|----|
| 22301 | I.281/40 | 18 | 39 | 8 | 15 | 12 | 35 | 10 |
| 22401 | I.281/50 | 21 | 49 | 10 | 17 | 14 | 43 | 16 |
| 22501 | I.281/65 | 23 | 64 | 12 | 19 | 16 | 56 | 22 |
| 22601 | I.281/80 | 26 | 79 | 13 | 21 | 17 | 70 | 37 |
| 22701 | I.281/90 | 28 | 89 | 14 | 22 | 19 | 79 | 49 |
| 22801 | I.281/100 | 31 | 100 | 16 | 25 | 20 | 89 | 66 |

I.281+x

| Codice | Descrizione | D | L | d6g | d1 | l | s | ⚖ |
|--------|-----------------|----|-----|-----|----|----|---|-----|
| 22311 | I.281/40+x-M6 | 18 | 40 | M6 | 15 | 13 | 4 | 28 |
| 22411 | I.281/50+x-M8 | 21 | 50 | M8 | 17 | 15 | 5 | 52 |
| 22511 | I.281/65+x-M8 | 23 | 65 | M8 | 19 | 17 | 6 | 86 |
| 22512 | I.281/65+x-M10 | 23 | 65 | M10 | 19 | 17 | 6 | 90 |
| 22611 | I.281/80+x-M10 | 26 | 80 | M10 | 21 | 18 | 6 | 132 |
| 22711 | I.281/90+x-M10 | 28 | 90 | M10 | 22 | 18 | 8 | 170 |
| 22811 | I.281/100+x-M12 | 31 | 102 | M12 | 25 | 20 | 8 | 245 |
| 22812 | I.281/100+x-M14 | 31 | 102 | M14 | 25 | 20 | 8 | 248 |

I.281+x-SST



| Codice | Descrizione | D | L | d6g | d1 | l | s | ⚖ |
|--------|---------------------|----|-----|-----|----|----|---|-----|
| 22312 | I.281/40+x-M6-SST | 18 | 40 | M6 | 15 | 13 | 4 | 28 |
| 22412 | I.281/50+x-M8-SST | 21 | 50 | M8 | 17 | 15 | 5 | 52 |
| 22513 | I.281/65+x-M8-SST | 23 | 65 | M8 | 19 | 17 | 6 | 87 |
| 22514 | I.281/65+x-M10-SST | 23 | 65 | M10 | 19 | 17 | 6 | 91 |
| 22612 | I.281/80+x-M10-SST | 26 | 80 | M10 | 21 | 18 | 6 | 133 |
| 22712 | I.281/90+x-M10-SST | 28 | 90 | M10 | 22 | 18 | 8 | 172 |
| 22813 | I.281/100+x-M12-SST | 31 | 102 | M12 | 25 | 20 | 8 | 247 |
| 22814 | I.281/100+x-M14-SST | 31 | 102 | M14 | 25 | 20 | 8 | 250 |

I.281+x+Gh

| Codice | Descrizione | D | L | d6g | d1 | l | s | ⚖ |
|--------|--------------------|----|-----|-----|----|----|---|-----|
| 22321 | I.281/40+x-M6+Gh | 18 | 45 | M6 | 15 | 8 | 4 | 33 |
| 22421 | I.281/50+x-M8+Gh | 21 | 55 | M8 | 17 | 10 | 5 | 56 |
| 22521 | I.281/65+x-M8+Gh | 23 | 70 | M8 | 19 | 12 | 6 | 90 |
| 22522 | I.281/65+x-M10+Gh | 23 | 71 | M10 | 19 | 12 | 6 | 98 |
| 22621 | I.281/80+x-M10+Gh | 26 | 86 | M10 | 21 | 12 | 6 | 143 |
| 22721 | I.281/90+x-M10+Gh | 28 | 96 | M10 | 22 | 12 | 8 | 180 |
| 22821 | I.281/100+x-M12+Gh | 31 | 109 | M12 | 25 | 13 | 8 | 256 |
| 22822 | I.281/100+x-M14+Gh | 31 | 109 | M14 | 25 | 13 | 8 | 262 |